

# Ball bearing butt hinge

## Description

Ball bearing butt hinge, square corners, steel galvanized, with removable pin

## Productgroup

1074

## Article number

1074.20.089K

## Photo



## Technical drawing

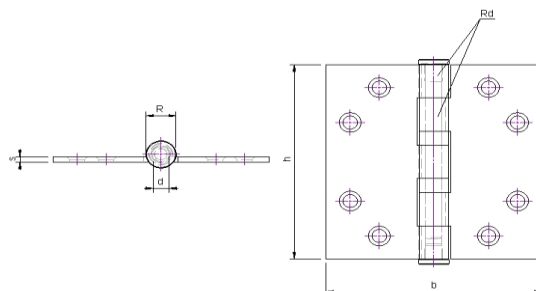

## Scope of application

Windows and Doors

## Technical data

### Material

Hinge	Steel
Finish surface	Galvanized
Bearing	Heavy duty ball bearings
Angle	Square corners
Pin	Steel
Weight	0,23 kg
Packaging Unit	10 pcs

## Product features

Heavy duty ball bearings  
Star-shaped, reduce the risk of screw breaking  
Flat head  
with removable pin

## Sizing

h	b	s	R	d	rd
89 mm	89 mm	2,5 mm	12 mm	7 mm	5 mm

## Maximum load

Number of hinges per door	3	4
Door weight	90 kg	100 kg

## Certificates

CE norm EN 1935: 374013011



## Components

Pin	A221.20.002V
Button	A320.20.003V
Bearing	A460.20.002V

## Assembly instructions

Screws to be used

Number	8 pcs
Measure	∅ 4*30 mm

Mounting Manual



Scharnieren