

# Ball bearing butt hinge

## Description

Ball bearing butt hinge, round corners, stainless steel brushed, with removable pin

## Productgroup

1076

## Article number

1076.80.102K

## Photo



## Technical drawing

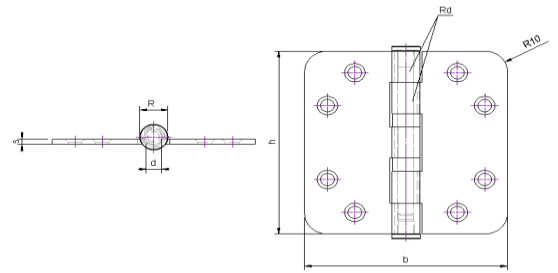

## Scope of application

Windows and Doors

## Technical data

### Material

Hinge	Stainless steel
Finish surface	Brushed
Bearing	Heavy duty ball bearings
Angle	Round corners
Pin	Stainless Steel
Weight	0,33 kg
Packaging Unit	10 pcs

## Product features

Heavy duty ball bearings  
Star-shaped, reduce the risk of screw breaking  
Flat Head  
With removable pin

## Sizing

h	b	s	R	d	rd
102 mm	102 mm	3 mm	13 mm	7 mm	5 mm

## Maximum load

Number of hinges per door	3	4
Door weight	100 kg	120 kg

## Components

Pin	A221.80.002V
Button	A320.80.015V
Bearing	A460.80.002V

## Assembly instructions

Screws to be used

Number	8 pcs
Measure	∅ 5*50 mm

Mounting Manual



Scharnieren