

Ball bearing butt hinge

Description

Ball bearing butt hinge, round corners, steel galvanized, with removable pin

Productgroup

1076

Article number

1076.20.089K

Photo



Technical drawing

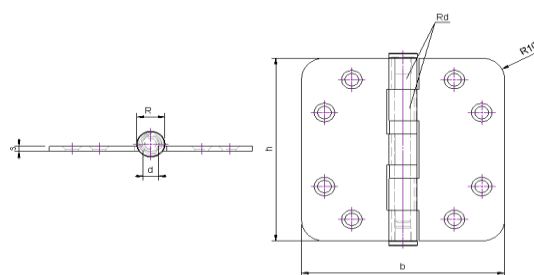

Scope of application

Windows and Doors

Technical data

Material

Hinge	Steel
Finish surface	Galvanized
Bearing	Heavy duty ball bearings
Angle	Round corners
Pin	Steel
Weight	0,23 kg
Packaging Unit	10 pcs

Product features

Heavy duty ball bearings
Star-shaped, reduce the risk of screw breaking
Flat head
with removable pin

Sizing

h	b	s	R	d	rd
89 mm	89 mm	2,5 mm	12 mm	7 mm	5 mm

Maximum load

Number of hinges per door	3	4
Door weight	90 kg	100 kg

Certificates

CE norm EN 1935: 374013011



Components

Pin	A221.20.002V
Button	A320.20.003V
Bearing	A460.20.002V

Assembly instructions

Screws to be used

Number	8 pcs
Measure	∅ 4.5*40 mm

Mounting Manual



Scharnieren