

# Ball bearing butt hinge

## Description

Ball bearing butt hinge, square corners, stainless steel brushed, with removable pin

## Productgroup

1074

## Photo



## Article number

1074.80.102K

## Technical drawing

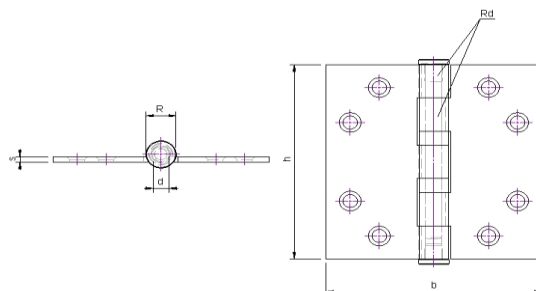

## Scope of application

Windows and Doors

## Technical data

### Material

Hinge	Stainless steel
Finish surface	Brushed
Bearing	Heavy duty ball bearings
Angle	Square corners
Pin	Stainless steel
Weight	0,33 kg
Packaging Unit	10 pcs

## Sizing

h	b	s	R	d	rd
102 mm	102 mm	3 mm	13 mm	7 mm	5 mm

## Certificates

CE norm EN 1935: 476014013



## Components

Pin	A221.80.005V
Button	A322.80.003V
Bearing	A460.80.002V

## Product features

Heavy duty ball bearings  
Star-shaped, reduce the risk of screw breaking  
Flat head  
with removable pin

## Maximum load

Number of hinges per door	3	4
Door weight	100 kg	120 kg

## Assembly instructions

Screws to be used

Number	8 pcs
Measure	∅ 5*50 mm

Mounting Manual



Scharnieren