

Ball bearing butt hinge

Description

Ball bearing butt hinge, square corners, stainless steel brushed, with removable pin

Productgroup

1074

Photo



Article number

1074.80.089K

Technical drawing

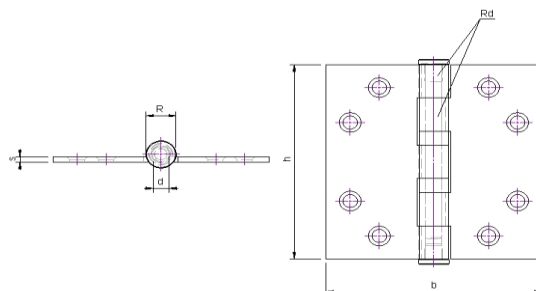

Scope of application

Windows and Doors

Technical data

Material

Hinge	Stainless steel
Finish surface	Brushed
Bearing	Heavy duty ball bearings
Angle	Square corners
Pin	Stainless steel
Weight	0,23 kg
Packaging Unit	10 pcs

Sizing

h	b	s	R	d	rd
89 mm	89 mm	2,5 mm	12 mm	7 mm	5 mm

Certificates

CE norm EN 1935: 374013011



Components

Pin	A221.80.002V
Button	A322.80.003V
Bearing	A460.80.002V

Product features

Heavy duty ball bearings
Star-shaped, reduce the risk of screw breaking
Flat head
with removable pin

Maximum load

Number of hinges per door	3	4
Door weight	90 kg	100 kg

Assembly instructions

Screws to be used

Number	8 pcs
Measure	∅ 4.5*40 mm

Mounting Manual



Scharnieren