

Description

Ball bearing butt hinge, square corners, brass polished, with removable pin

Productgroup

1074

Article number

1074.50.076K

Photo



Technical drawing

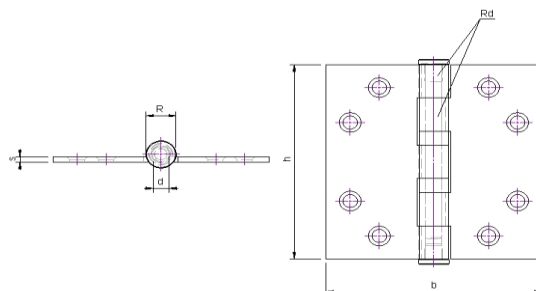

Scope of application

Windows and Doors

Technical data

Material

Hinge	Brass
Finish surface	Polished
Bearing	Heavy duty ball bearings
Angle	Square corners
Pin	Brass
Weight	0,24 kg
Packaging Unit	10 pcs

Product features

Heavy duty ball bearings
Flat head
with removable pin

Sizing

h	b	s	R	d	rd
76 mm	76 mm	2 mm	10 mm	6 mm	5 mm

Maximum load

Number of hinges per door	3	4
Door weight	50 kg	60 kg

Components

Pin	A221.50.002V
Button	A322.50.003V
Bearing	A460.50.002V

Assembly instructions

Screws to be used

Number	8 pcs
Measure	∅ 4*30 mm

Mounting Manual



Scharnieren