

Ball bearing butt hinge

Description

Ball bearing butt hinge, square corners, steel galvanized, with removable pin

Productgroup

1074

Article number

1074.20.102K

Photo



Technical drawing

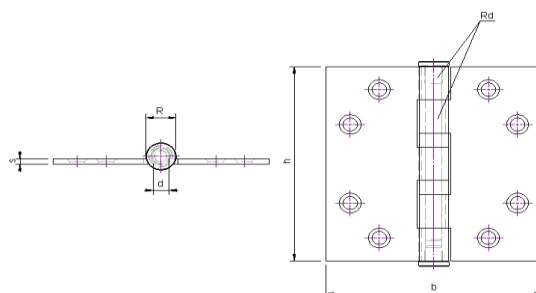

Scope of application

Windows and Doors

Technical data

Material

Hinge	Steel
Finish surface	Galvanized
Bearing	Heavy duty ball bearings
Angle	Square corners
Pin	Steel
Weight	0,33 kg
Packaging Unit	10 pcs

Product features

Heavy duty ball bearings
Star-shaped, reduce the risk of screw breaking
Flat head
with removable pin

Sizing

h	b	s	R	d	rd
102 mm	102 mm	3 mm	13 mm	7 mm	5 mm

Maximum load

Number of hinges per door	3	4
Door weight	100 kg	120 kg

Certificates

CE norm EN 1935: 476013013



Components

Pin	A221.20.005V
Button	?
Bearing	A460.20.002V

Assembly instructions

Screws to be used

Number	8 pcs
Measure	∅ 5*40 mm

Mounting Manual



Scharnieren