

Ball bearing butt hinge

Description

Ball bearing butt hinge, round corners, steel galvanized, swaged with removable pin

Productgroup

1066

Photo



Article number

1066.20.089K

Technical drawing

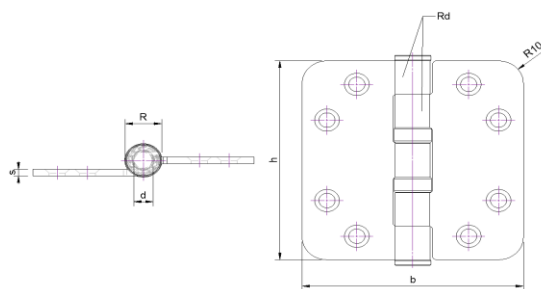

Scope of application

Windows and Doors

Technical data

Material

Hinge	Steel
Finish surface	Galvanized
Bearing	Heavy duty ball bearings
Angle	Round corners
Pin	Steel
Weight	0,27 kg
Packaging Unit	10 pcs

Sizing

h	b	s	R	d	rd
89 mm	89 mm	3 mm	14 mm	8 mm	5 mm

Certificates

CE norm EN 1935:475013012



Components

Pin	A221.20.013V
Button	A320.20.015V
Bearing	A460.80.009V

Product features

Star-shaped, reduce the risk of screw breaking
Flat head
with removable pin
swaged

Maximum load

Number of hinges per door	3	4
Door weight	120 kg	150 kg

Assembly instructions

Screws to be used

Number	8 pcs
Measure	∅ 4.5*40 mm

Mounting Manual



Scharnieren