

Description

Friction-bearing hinge, round corners, steel galvanized, with removable pin

Productgroup

1065

Article number

1065.20.089K

Photo



Technical drawing

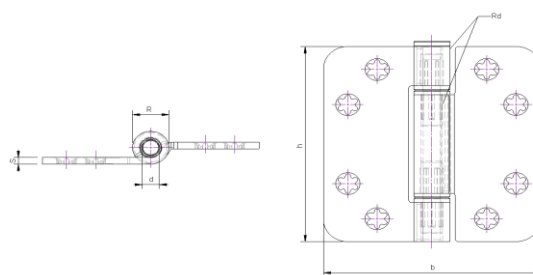

Scope of application

Windows and Doors

Technical data

Material

Hinge	Steel
Finish surface	Galvanized
Bearing	Friction-bearing
Angle	Round corners
Pin	Steel
Weight	0,28 kg
Packaging Unit	10 pcs

Product features

Star-shaped, reduce the risk of screw breaking
Flat head
with removable pin

Sizing

h	b	s	R	d	rd
89 mm	89 mm	3 mm	14 mm	7 mm	3 mm

Maximum load

Number of hinges per door	3	4
Door weight	140 kg	160 kg

Certificates

CE norm EN 1935: 476013013



Components

Pin	110319
Bearing	110321

Assembly instructions

Screws to be used

Number	8 pcs
Measure	∅ 4.5*40 mm

Mounting Manual



Scharnieren