

Description

Butt hinge, square corners, stainless steel brushed, with removable pin

Productgroup

1050

Photo

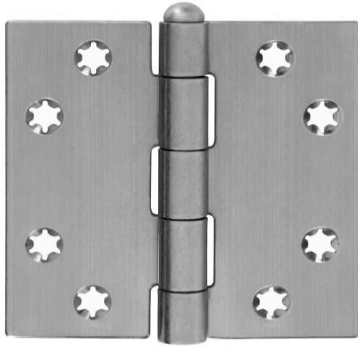

Article number

1050.80.089K

Technical drawing

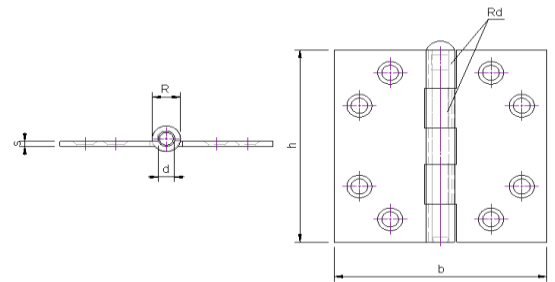

Scope of application

Windows and Doors

Technical data

Material

Hinge	Stainless steel
Finish surface	Brushed
Bearing	Bearing-free
Angle	Square corners
Pin	Stainless steel
Weight	0,22 kg
Packaging Unit	10 pcs

Sizing

h	b	s	R	d	rd
89 mm	89 mm	2,5 mm	12 mm	7 mm	5 mm

Certificates

CE norm EN 1935:273013010



Components

Pin A 201.80.004 V

Product features

Star-shaped, reduce the risk of screw breaking
Roundhead
with removable pin

Maximum load

Number of hinges per door	3	4
Door weight	70 kg	80 kg

Assembly instructions

Screws to be used

Number	8 pcs
Measure	∅ 4,5*40 mm

Mounting Manual



Scharnieren