

## Description

Butt hinge, square corners, stainless steel brushed, with removable pin

## Productgroup

1050

## Article number

1050.80.076A

## Photo

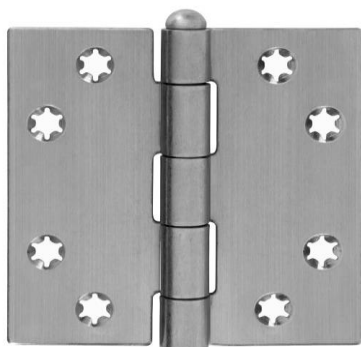

## Technical drawing

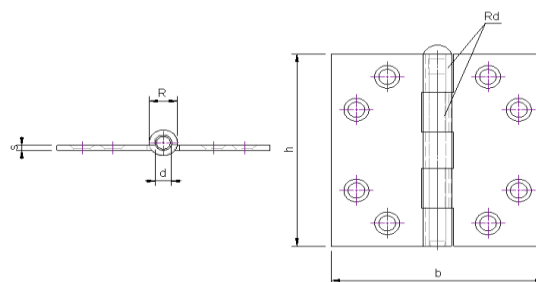

## Scope of application

Windows and Doors

## Technical data

### Material

Hinge	Stainless steel
Finish surface	Brushed
Bearing	Bearing-free
Angle	Square corners
Pin	Stainless steel
Weight	0,13 kg
Packaging Unit	25 pcs

## Sizing

h	b	s	R	d	rd
76 mm	76 mm	2 mm	10 mm	6 mm	5 mm

## Certificates

CE norm EN 1935: 14301309

## Components

Pin A 201.80.003 V

## Product features

Star-shaped, reduce the risk of screw breaking  
Roundhead  
with removable pin

## Maximum load

Number of hinges per door	3	4
Door weight	50 kg	60 kg

## Assembly instructions

Screws to be used

Number 8 pcs  
Measure  $\varnothing$  4\*30 mm

Mounting Manual



Scharnieren