

Description

Butt hinge, square corners, brass polished, with removable pin

Productgroup

1050

Photo



Article number

1050.50.076A

Technical drawing

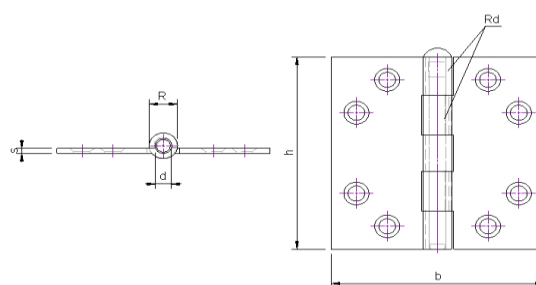

Scope of application

Windows and Doors

Technical data

Material

Hinge	Brass
Finish surface	Polished
Bearing	Bearing-free
Angle	Square corners
Pin	Brass
Weight	0,13 kg
Packaging Unit	25 pcs

Sizing

h	b	s	R	d	rd
76 mm	76 mm	2 mm	10 mm	6 mm	5 mm

Certificates

CE norm geen keur



Components

Pin A 201.50.003 V

Product features

Star-shaped, reduce the risk of screw breaking
Roundhead
with removable pin

Maximum load

Number of hinges per door	3	4
Door weight	50 kg	60 kg

Assembly instructions

Screws to be used

Number	8 pcs
Measure	∅ 4*30 mm

Mounting Manual



Scharnieren