

## Description

Butt hinge, square corners, brass polished, with removable pin

## Productgroup

1050

## Photo



## Article number

1050.50.063A

## Technical drawing

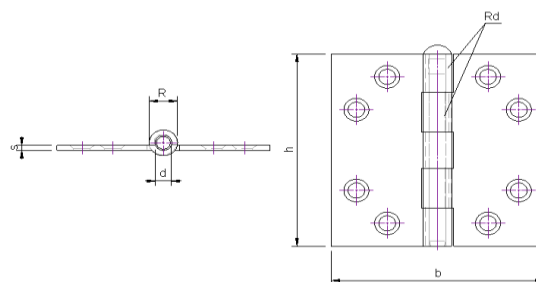

## Scope of application

Windows and Doors

## Technical data

### Material

Hinge	Brass
Finish surface	Polished
Bearing	Bearing-free
Angle	Square corners
Pin	Brass
Weight	0,09 kg
Packaging Unit	25 pcs

## Sizing

h	b	s	R	d	rd
63,5 mm	63,5 mm	2 mm	9,8 mm	5,5 mm	5 mm

## Product features

Star-shaped, reduce the risk of screw breaking  
Roundhead  
with removable pin

## Maximum load

Number of hinges per door	3	4
Door weight	25 kg	30 kg

## Assembly instructions

Screws to be used

Number	6 pcs
Measure	∅ 4*30 mm

Mounting Manual



Scharnieren

## Components

Pin A 201.50.008 V