

# Butt hinge

## Description

Butt hinge, square corners, steel galvanized, with removable pin

## Productgroup

1050

## Article number

1050.20.076A

## Photo



## Technical drawing

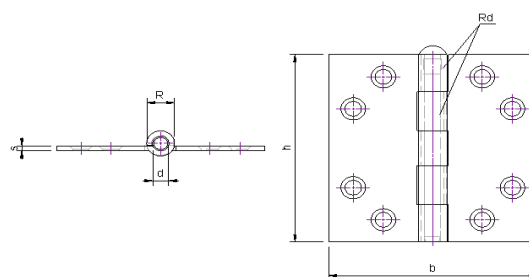

## Scope of application

Windows and Doors

## Technical data

### Material

Hinge	Steel
Finish surface	Galvanized
Bearing	Bearing-free
Angle	Square corners
Pin	Steel
Weight	0,1 kg
Packaging Unit	25 pcs

## Product features

Star-shaped, reduce the risk of screw breaking  
Roundhead  
with removable pin

## Sizing

h	b	s	R	d	rd
76 mm	76 mm	2 mm	10 mm	6 mm	5 mm

## Maximum load

Number of hinges per door	3	4
Door weight	50 kg	60 kg

## Certificates

CE norm EN 1935: 14301309



## Components

Pin A 201.20.003 V

## Assembly instructions

Screws to be used

Number	8 pcs
Measure	∅ 4*30 mm

Mounting Manual



Scharnieren