

Description

Butt hinge, square corners, steel galvanized, with removable pin

Productgroup

1050

Article number

1050.20.063A

Photo



Technical drawing

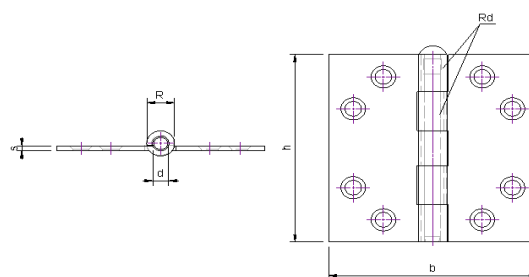

Scope of application

Windows and Doors

Product features

Star-shaped, reduce the risk of screw breaking
Roundhead
with removable pin

Technical data

Material

Hinge	Steel
Finish surface	Galvanized
Bearing	Bearing-free
Angle	Square corners
Pin	Steel
Weight	0,1 kg
Packaging Unit	25 pcs

Sizing

h	b	s	R	d	rd
63,5 mm	63,5 mm	2 mm	9,8 mm	5,5 mm	5 mm

Maximum load

Number of hinges per door	3	4
Door weight	25 kg	30 kg

Assembly instructions

Screws to be used

Number	6 pcs
Measure	∅ 4*30 mm

Mounting Manual



Scharnieren

Components

Pin A 201.20.008 V