

# Butt hinge

## Description

Butt hinge, square corners, steel galvanized, with removable pin

## Productgroup

1050

## Article number

1050.20.050A

## Photo



## Technical drawing

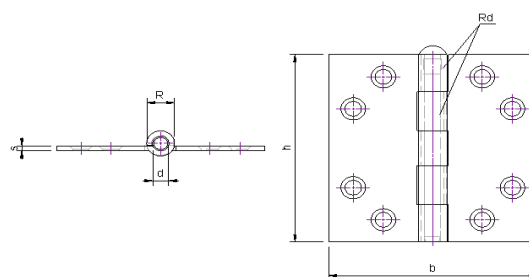

## Scope of application

Windows and Doors

## Technical data

### Material

Hinge	Steel
Finish surface	Galvanized
Bearing	Bearing-free
Angle	Square corners
Pin	Steel
Weight	0,1 kg
Packaging Unit	25 pcs

## Product features

Star-shaped, reduce the risk of screw breaking  
Roundhead  
with removable pin

## Sizing

h	b	s	R	d	rd
50 mm	50 mm	2 mm	8,3 mm	4 mm	3 mm

## Maximum load

Number of hinges per door	3	4
Door weight	15 kg	25 kg

## Assembly instructions

Screws to be used

Number	4 pcs
Measure	∅ 3,5*30 mm

Mounting Manual



Scharnieren

## Components

Pin A 200.20.002 V